

## Decorative Hardware



### Threaded Screws M4

Combined slot, suitable for flat or cross blades.

Finish: steel, zinc-plated

Length	Cat. No.
10 mm	022.35.109
12 mm	022.35.127
15 mm	022.35.154
18 mm	022.35.181
20 mm	022.35.207
22 mm	022.35.225
23 mm	022.35.234
25 mm	022.35.252
28 mm	022.35.289
30 mm	022.35.305
35 mm	022.35.350
38 mm	022.35.387
40 mm	022.35.403
45 mm	022.35.458
50 mm	022.35.501
60 mm	022.35.609
75 mm	022.35.750
80 mm	022.35.800
85 mm	022.35.850
90 mm	022.35.900
95 mm	022.35.950
100 mm	022.35.990

Packing: 100 and 1000 pcs.



### Threaded Breakoff Screw M4

Combined slot, suitable for flat or cross blades.

Finish: steel, zinc-plated

Length	Cat. No.
1 3/4" x 3/4"	022.35.887

Packing: 100 and 500 pcs.

Dimensional data not binding.  
We reserve the right to alter specifications without notice.

**131 A**

TCH 04

## Modern Zinc Handles and Knobs



Copper

Cat. No.	166.07.001
----------	------------

Packing: 25 pcs.

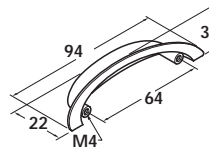

Pewter

Cat. No.	166.07.901
----------	------------

Packing: 25 pcs.

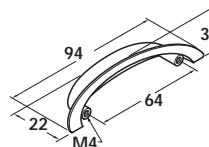

Pewter and copper

Cat. No.	100.28.902
----------	------------

Packing: 25 pcs.

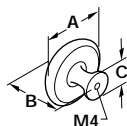
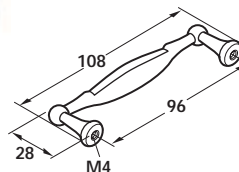

Pewter and copper

Size A x B	Dimension C	Cat. No.
25 x 20	14	131.04.091
35 x 25	17	131.04.092
40 x 27	20	131.04.093

Packing: 25 pcs.