

# Wire Basket Pull-Out Storage System

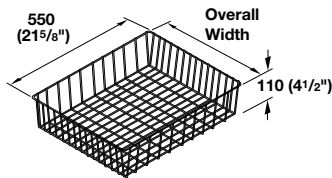
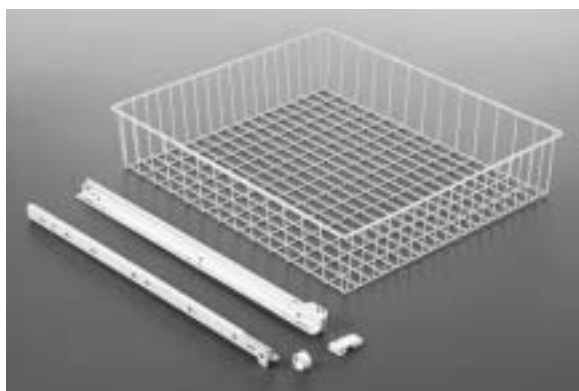

\* Installed width without spacers. The spacers permit the system installation width to be expanded on each side from 3 mm to 21 mm (max.).

## Wire basket pull-out storage system sets

cabinet depth min. 550 mm (21<sup>5</sup>/<sub>8</sub>").  
complete with 1 basket, 1 pair Soft-Roller drawer runners, 8 basket fixing brackets with Hospa-screws, 4 spacers, 15 mm thick.

Load capacity: 20 kg (44 lbs.)

Soft-Roller extension length: 447 mm (17<sup>5</sup>/<sub>8</sub>")

Finish: steel/steel-wire, epoxy-coated, white  
brackets and spacers: plastic, white

Installation width*		Overall width		Cat. No.
mm	inch	mm	inch	
255	10	242	9½	540.20.718
331	13	318	12½	540.20.727
407	16	394	15½	540.20.736
483	19	470	18½	540.20.745

Packing: 1 set

**HÄFELE**  
at  
**cabinet :: accessories**  
U N L I M I T E D



Complete with Soft-Roller drawer runners.

**Kitchen Accessory Systems**

**5**

## Optional bottom-mount bracket

For Soft-Roller drawer runners bracket.  
4 each required per basket.  
Finish: steel, plastic-coated, white

Cat. No. 540.20.905

Packing: per set of 4 pcs. with screws

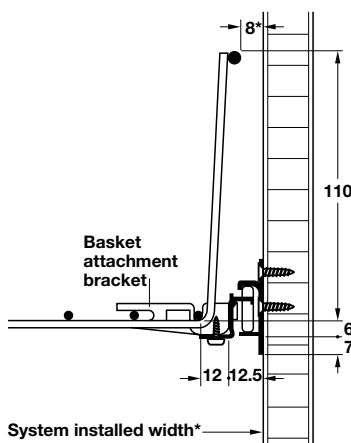
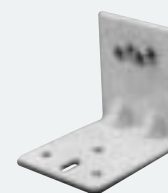

## Stackable spacers

for adequate clearance for the projecting door hinges on the hinge-side of the cabinet

Finish: plastic, white

Cap thickness:	4 mm	3 mm	5 mm	9 mm
Cat. No.	037.93.708	037.93.717	037.93.726	037.93.735

Packing: 100 pcs

Total spacer thickness not to exceed 21 mm

**Dimensions in mm  
Inches are approximate**

Dimensional data not binding.  
We reserve the right to alter specifications without notice.