

88 5530 78

Mirror

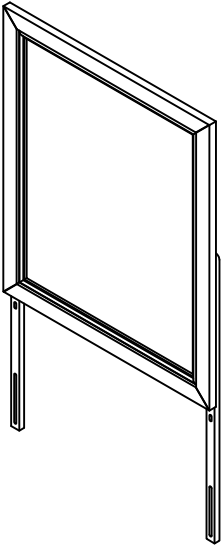

IMPORTANT NOTE

Carefully remove all the parts from the carton and put them individually on a soft cloth to prevent scratches or other damages occuring to the wood parts.

We have taken great care in the design of this product and request that you carefully and strictly follow our assembly instructions to ensure a completed product as it was designed.

Home
Styles

Part List

A.
Mirror
1 pc.

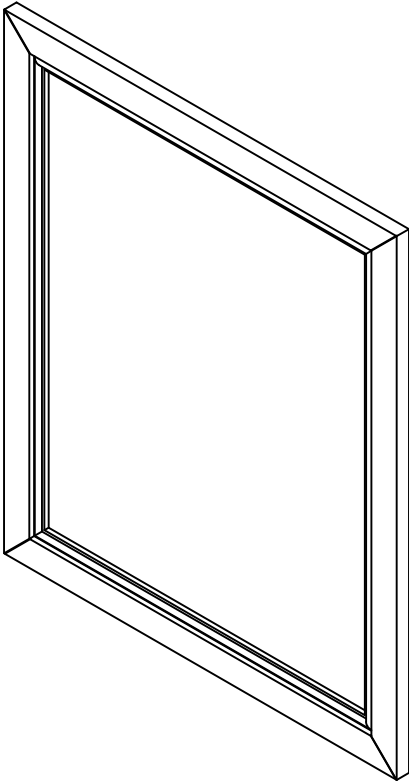

B.
Mirror Support
2 pcs.

Hardware List

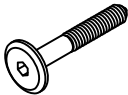

(M6x40)
Head Cap Bolt (Long)
4 pcs. (+1 extra)

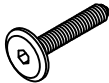

(M6x30)
Head Cap Bolt (Short)
4 pcs. (+1 extra)



Spring Washer
8 pcs. (+1 extra)



Flat Washer
8 pcs. (+1 extra)

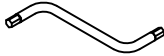

Key Wrench
1 pc.



Small Key Wrench
1 pc.

Assembly Instructions 2/3

IMPORTANT

- * Do not tighten up all the screws until each part is properly assembled.
- * You should keep Key Wrench in a safe place as you may need to tighten up the Head Cap Bolts in the future.
- * Use a soft cloth between these parts and the floor.

STEP 1

Carefully place Mirror (A) face down on a soft cloth.

HORIZONTAL

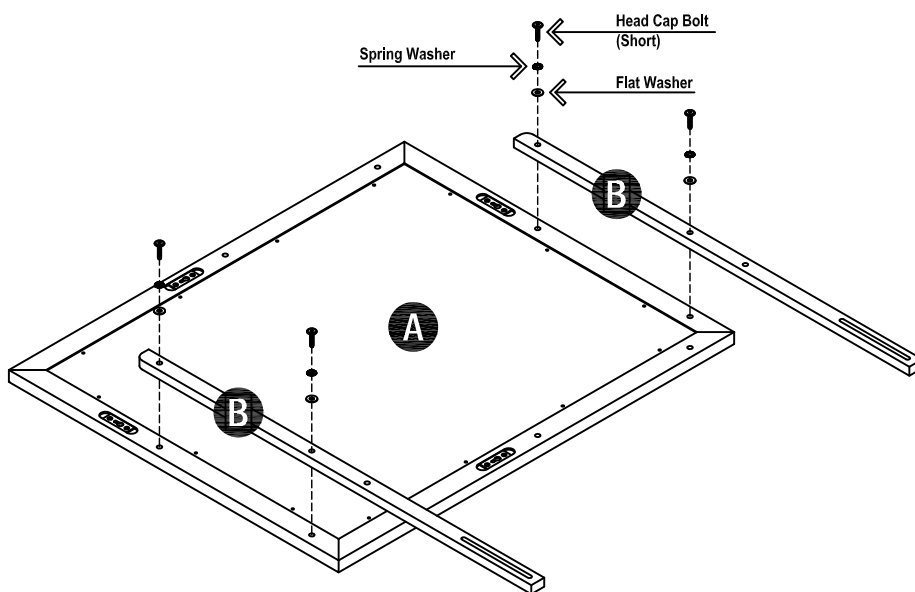

Attach Mirror Supports (B) to Mirror (A) in horizontal or vertical position with Head Cap Bolts (Short), Spring Washers and Flat Washers.

Tighten with Key Wrench.
(See Figure 1)

VERTICAL

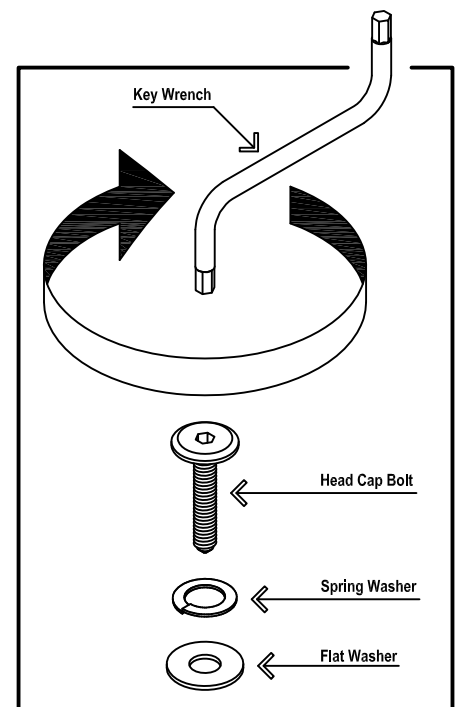
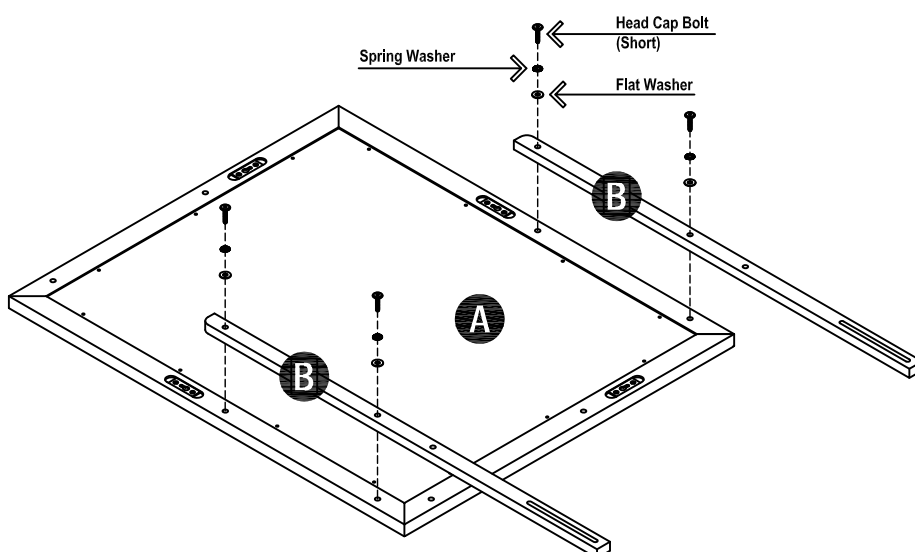

Figure 1

Assembly Instructions 3/3

STEP 2

Attach the unit in horizontal or vertical position to Dresser (carton 88 5530 43) with Head Cap Bolts (Long), Spring Washers and Flat Washers.

Tighten with Key Wrench.
(See Figure 1)

HORIZONTAL

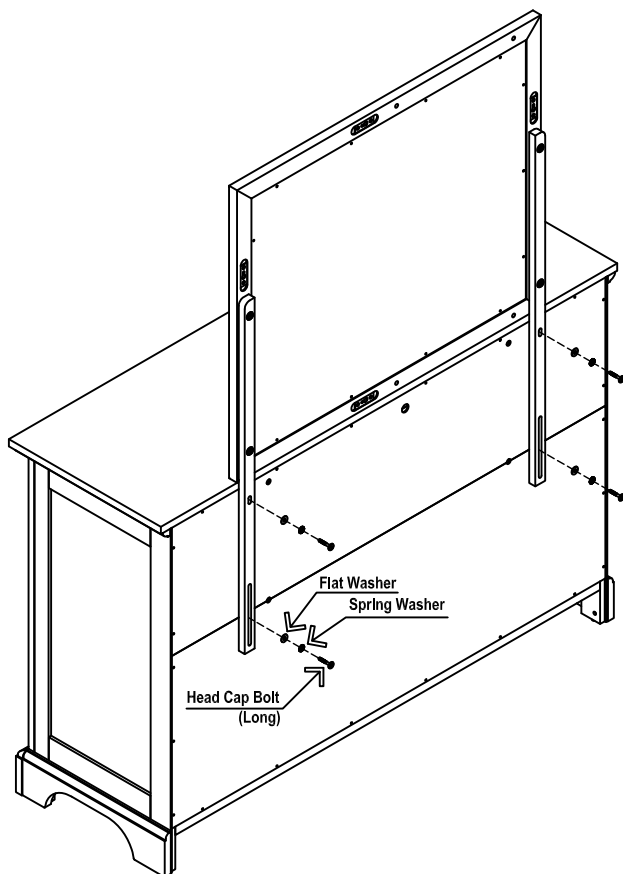

VERTICAL

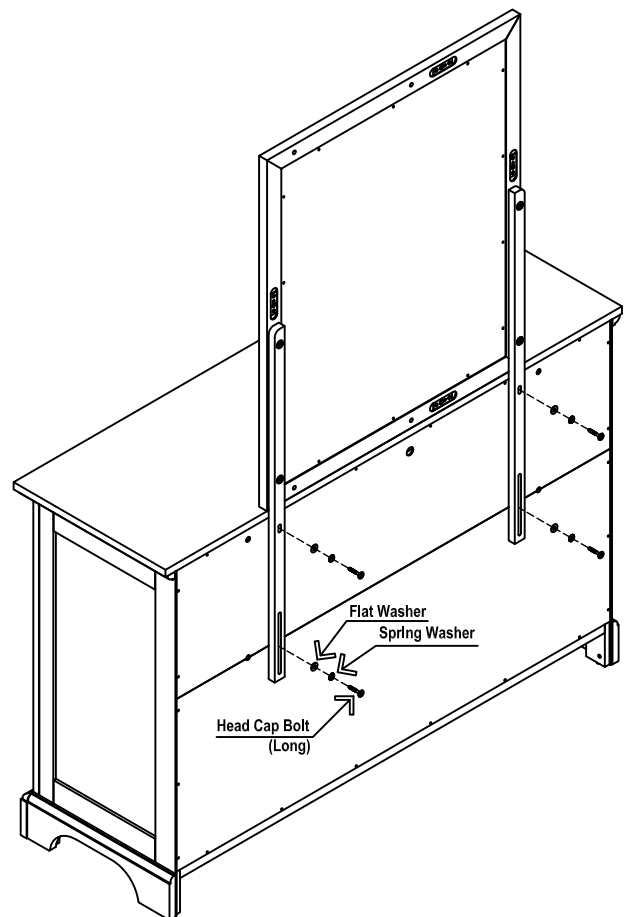

VERY IMPORTANT !!

CARE INSTRUCTIONS

NEVER

USE GLASS CLEANERS ON FINISHED FURNITURE. AMMONIA WILL CHEMICALLY ATTACK THE FINISH.

NEVER

ALLOW LIQUIDS OF ANY KIND TO REMAIN ON THE FURNITURE. ABSORPTION CAUSES PART TO WARP AND SPLIT AND FINISHES TO DELAMINATE.

DO NOT
WRITE
DIRECTLY
ON
SURFACE.



**PREVENT
MARKING**

DO NOT
PLACE IN
DIRECT
SUNLIGHT.



**PREVENT
FADING**

DO NOT USE
COMMERCIAL
WAXES AND
POLISHES.



**PREVENT
YELLOWING**

DO NOT
PLACE HOT
OBJECTS
ON SURFACE.



**PREVENT
FINISH DAMAGE**

DO NOT
USE
RUBBER
BASED
PLACE MATS.



**PREVENT
DISCOLORING**

TO CLEAN

USE A SOFT CLOTH MOISTENED IN LUKEWARM SOAP AND WATER, THEN BUFF WITH A DRY CLEAN CLOTH.



Home Styles will provide replacements free of charge for missing or damaged hardware or parts within 30 days of purchase. Digital images of the defective parts may be required. If this product was not purchased from an authorized retail affiliate, Home Styles is under no obligation to provide replacement parts. Parts are not available for fully assembled items nor are parts available for sale.