



"BT3S" Maple Top Work Tables

w/ 1 3/4" thick Hard Rock Maple Top
w/ 3- Drawer Tier Unit
w/ Stainless Steel Base



AUTOQUOTES



**1-3/4" Maple
Top w/ 4"
Coved Riser
Back & Both**

30" WIDE	Qty
BT3S01	
BT3S02	
BT3S03	
BT3S03A	
BT3S04	

FEATURES:

- * 1 3/4" Thick Hard Rock Maple Top
top style "SC" flat top w/ 4" Coved Riser Back and Both Ends
- * Maple top is finished with penetrating oil
with optional natural clear Varnique Finish
- * Stainless Steel Base and Bracing
Type 300 stainless steel with # 4 polish, satin finish
- * Adjustable bullet feet
- * Shipped Standard K.D.
- * Optional drawers, casters, pot racks, etc. available
- * All models are approved by the National Sanitation Foundation

CONSTRUCTION:

Base: Stainless Steel Bases are TIG welded, Exposed welds are polished to match adjacent surface.

MATERIAL:

Top: Laminated Hard Rock Maple
Drawer Panels - 22 gauge
Unit: Front Drawer Pulls - 14 gauge
Reinforced with 1-1/2" Square O.D. tubing
*All type 300 stainless steel. # 4 polish, satin finish
Bracing: 1 1/4" Round O.D. 18 gauge type 300 tubular stainless steel
4 polish, satin finish
Legs: 1 5/8" Round O.D., 16 gauge type 300 tubular stainless steel
4 polish, satin finish
Gussets: Stainless Steel
Feet: 1" adjustable stainless steel bullet feet

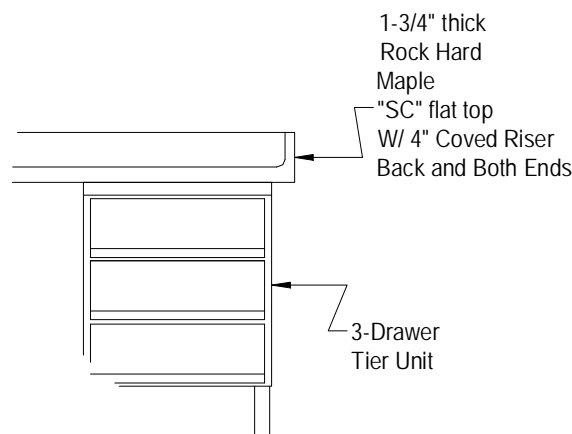

OPTIONAL ACCESSORIES

	MODEL #	Qty
DRAWER LOCK		
CASTERS		
OVERSHELVES		
POT RACK		
VERTICAL COVER CORNER		

John Boos & Co

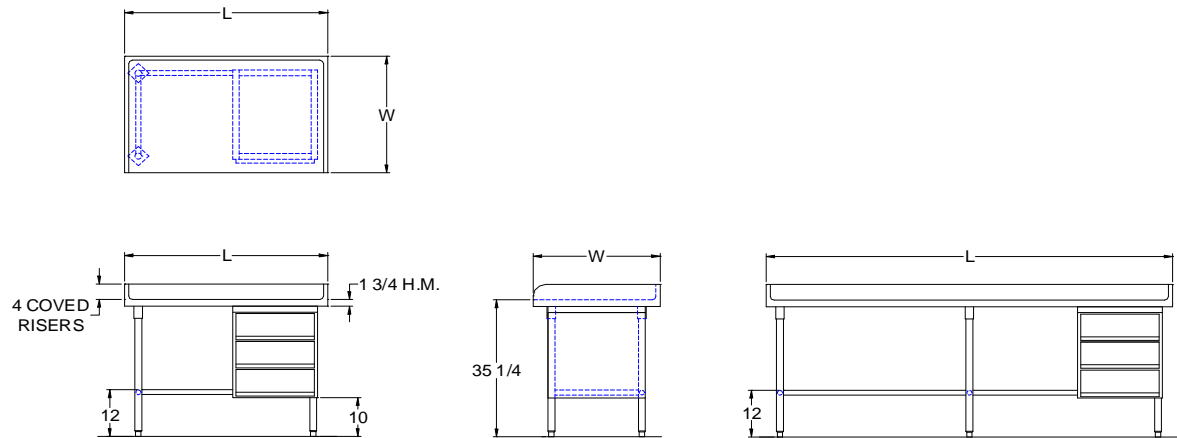

Shipped Knocked Down

Units 7 ft. and larger are furnished with six legs.

All dimensions are typical.

Tolerance +/- .500".

1-3/4" Flat Top w/ 4" Coved Riser Back & Both Ends

48	BT3S01	165
60	BT3S02	190
72	BT3S03	215
84	BT3S03A	241
96	BT3S04	267

John Boos & Co



John Boos is constantly engaged in a program of improving products and therefore reserves the right to change specification without prior notice

July 2013