

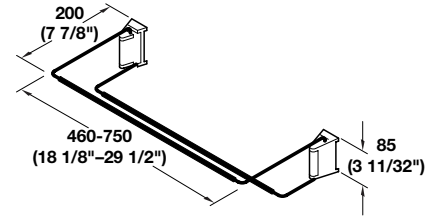

Shoe holder
for screw-mounting
extendable from 460 - 750 mm (18 1/8" - 29 1/2")
Finish: steel, chrome-plated
Mounting parts: plastic, black

Cat. No.	892.12.206
----------	------------

Packing: 6 pcs.



Mounting
of the shoe holder is
accomplished by screws
(customer provided)

Wall Track for above
height adjustable
entire length: 1120 mm (44") including end caps
Finish: Rail: aluminum, black oxidized
End caps: plastic, black

Cat. No.	892.12.390
----------	------------

Packing: 1 pair

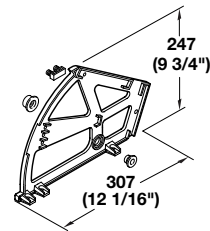
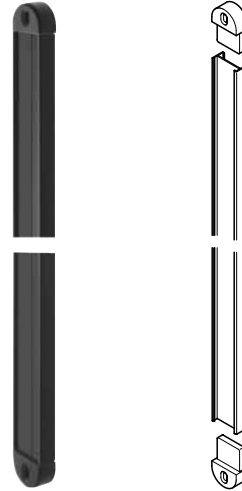

Tilt fitting
for installation in shoe cabinets, 3 sections
Finish: plastic, white

Cat. No.	892.14.737
----------	------------

for 3 partitions

Packing: 10 sets, incl. mounting material

Shoe Rack
Adjustable from
560 - 1000 mm

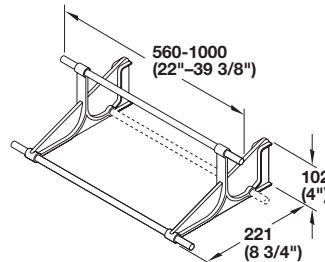

Finish: Rod: steel, black
Mounting parts: plastic, black

Cat. No.	892.11.300
----------	------------

Packing: 1 pc.



**Organizational Products
for Kitchen, Bath, Closet
and Home Entertainment**



Dimensional data not binding.
We reserve the right to alter
specifications without notice.