

HÄFELE
at

cabinet accessories
UNLIMITED

Table Legs - Tapered



- Leg tapers from:
75 mm (3") to 28 mm (1 1/8")
- Static load rating approximately
100 kg (220 lbs.) per leg.



- Ball joint foot adjusts for
uneven floors.
- Leg tapers from:
60 mm (2 3/8") to 32 mm (1 1/4")

**Tables, Legs, Casters,
Levelers and Office
Organization**

Dimensional data not binding.
We reserve the right to alter
specifications without notice.

1222

TCH 04



Tapered and flared aluminum table leg, with adjustable foot, screw mounts to underside of table tops.
Adjustable range: +15 mm (5/8")
Finish: Leg: aluminum, polished
Adjustment foot: plastic, black
Mounting plate: aluminum, 195 mm x 170 mm (7 3/4" x 6 3/4")

Height	Diameter	Cat. No.
710 mm (28")	75 mm (3")	635.43.071

Packing: 1 pair (2 pc.)



Tapered and flared table leg, with adjustable foot. Screw mounts to underside of table. Welded on mounting plate. Adjustable range: +20 mm (3/4")
Finish: Leg: tubular steel
Adjustment foot: plastic, black
Mounting plate: steel

Height	Diameter	Finish of leg	Cat. No.
710 mm (28")	60 mm (2 3/8")	nickel matt	635.42.671
		black matt epoxy	635.42.371

Packing: 1 set (4 pcs.)

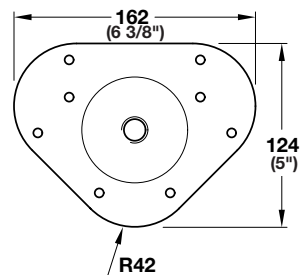

Dimensions in mm
Inches are approximate

Hafele at www.haef.com is a division of **cabinet accessories**
UNLIMITED