



T-Q-WR96



T-Q-1Z-WC-RF-Color

Dimming Components

Part Number	Description and Use
T-Q-WR96	96W Wireless LED dimming receiver. Allows you to control different Zones independently or in a group. Use with T-Q-1Z-WC-RF-Color.
T-Q-1Z-WC-RF-Color	UNO 1-Zone LED controller. Can control up to 1 Zone with one controller. Use with T-Q-WR96 receiver or T-Q-WR240 receiver. Available in Almond (AL), Black (BK), Brown (BR), Gray (GR), or White (WT)

Tools Needed

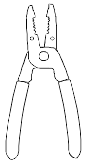

Wire Strippers

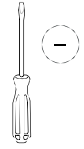

Flat Head Screwdriver

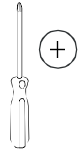

#1 Phillips Screwdriver

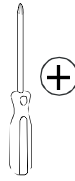

#2 Phillips Screwdriver

Product Legend



Male Barrel Connector T-MBC



Female Barrel Connector T-FBC



EZ Connector L-8MM-EZ



Factory installed Male Plug



Factory installed Female Plug

Connect Power Supply to Receiver

Plug-In Power Supply

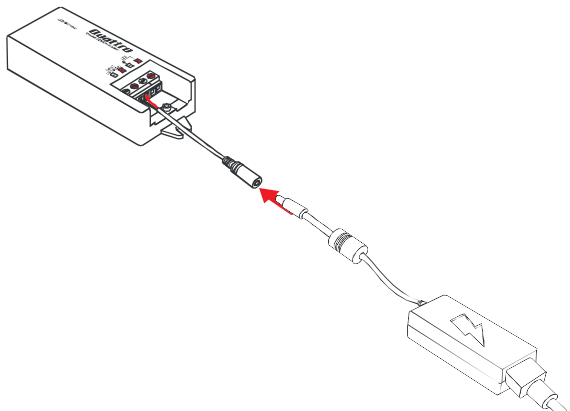

Insert the Male Barrel Connector on the Power Supply into the Female Plug Cable on the Receiver.

Waterproof Hardwired Power Supply

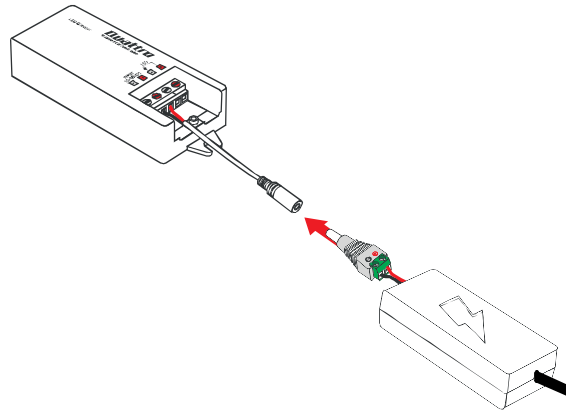

Wire a Male Barrel Connector to the output wires on the low voltage side Power Supply, Red wire to (V+), Black wire to (V-). Plug into Female Plug Connector on the Receiver.

Option 1: Connect Receiver to Tape Light with 8MM-EZ Connector

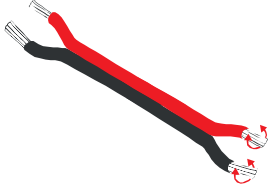

1. Cut a length of connection wire to run from Receiver to Tape Light location. Strip 1/4" insulation from both ends of wire, twist each wire, and fold stripped wires in half.

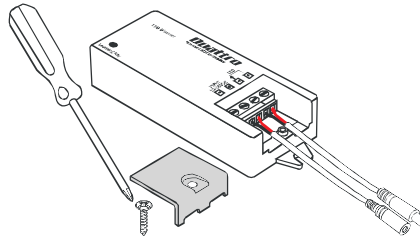

2. Use #2 Phillips to loosen screw and remove cover from Receiver.

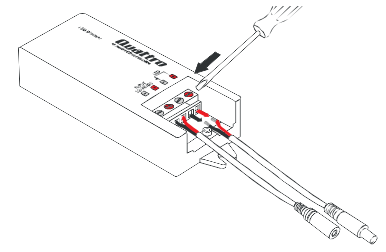

3. Use a flat blade screwdriver to loosen terminals for the Male Plug and remove.

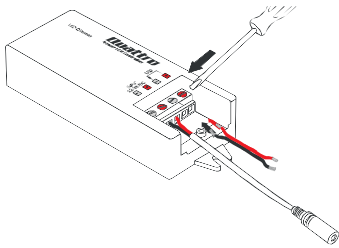

4. Insert one end of stripped wires into Receiver LED terminals, Red wire to (+) and Black wire to (-) terminals. Tighten screws.

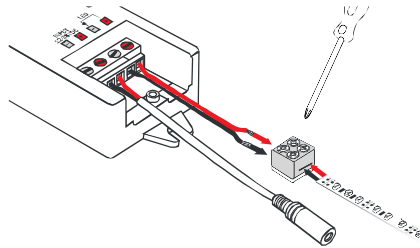

5. Use #1 Phillips to loosen the 4 terminal screws on 8MM-EZ Connector. Peel 1/2" of the adhesive protector from back of LED tape light, insert into connector, evenly tighten screws. Insert wires from Receiver into terminals, Red wire to (+) side of tape, Black wire to (-) side of tape; tighten screws.

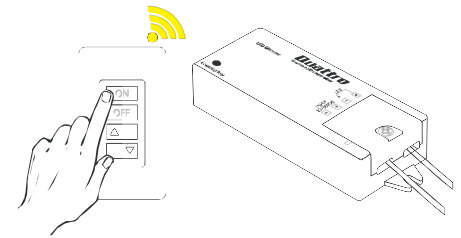

6. Turn on 120V AC to Power Supply and pair Receiver to Controller.

Option 2: Connect Receiver to Tape Light with Female Barrel Connector & 8MM-EZ Connector

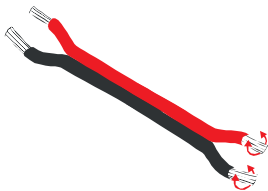

1. Cut a length of connection wire to run from Receiver to Tape Light location. Strip 1/4" insulation from both ends of wire, twist each wire, and fold stripped wires in half on both ends.

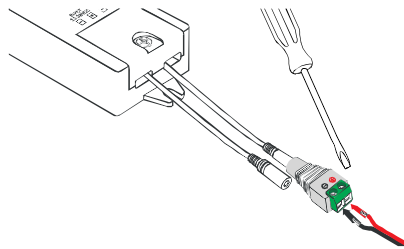

2. Insert Male Plug on Receiver into Female Barrel Connector. Use Flat blade screwdriver to loosen screws on Female Barrel Connector. Insert wires, Red wire to (+), Black wire to (-), and tighten screws.

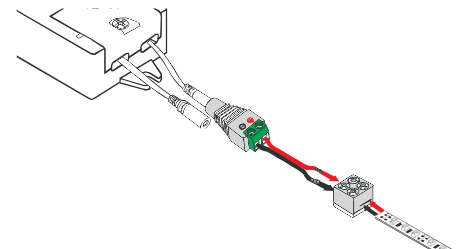

3. Use #1 Phillips to loosen the 4 terminal screws on 8MM-EZ Connector. Peel 1/2" of the adhesive protector from back of LED tape light, insert into connector, evenly tighten screws. Insert wires from Receiver into terminals, Red wire to (+) side of tape, Black wire to (-) side of tape; tighten screws.

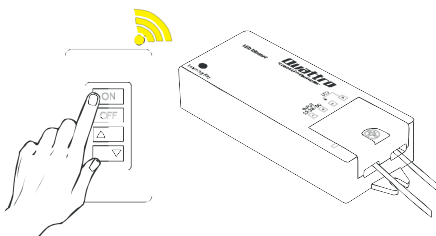

4. Turn on 120V AC to Power Supply and pair Receiver to Controller.

Option 1: Connect Receiver to Puck Light with factory installed plugs

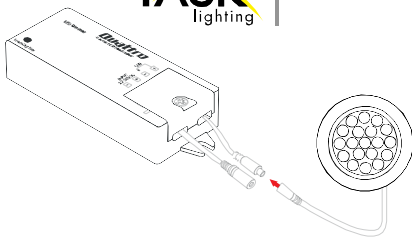

1. Insert Male Plug on Receiver into Female Plug on Puck Light.

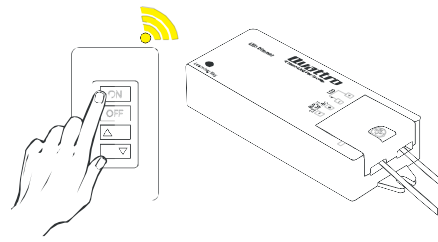

2. Turn on 120V AC to Power Supply and pair Receiver to Controller.

Option 2: Connect Receiver to Puck Light with Barrel Connector and EZ-WSC Connector

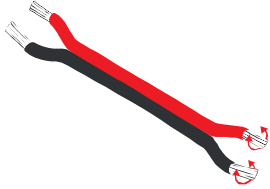

1. Cut a length of connection wire to run from Receiver to Puck Light location. Strip 1/4" insulation from both ends of wire, twist each wire, and fold stripped wires in half.

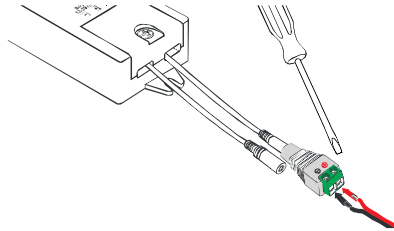

2. Insert Male Plug on Receiver into Female Barrel Connector. Use Flat blade screwdriver to loosen screws on Female Barrel Connector. Insert wires, Red wire to (+), Black wire to (-), and tighten screws. Insert the other end of wires into EZ-WSC Connector.

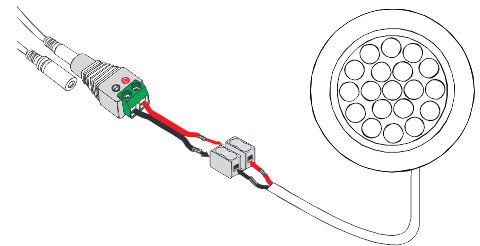

3. Cut Female Plug on Puck Light and insert wires, matching Red wire to Red, Black wire to Black into EZ-WSC Connector.

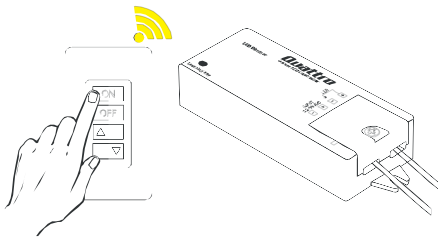

4. Turn on 120V AC to Power Supply and pair Receiver to Controller.

Option 3: Connect Receiver to Puck Light with Barrel Connectors

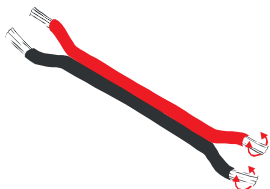

1. Cut a length of connection wire to run from Receiver to Puck Light location. Strip 1/4" insulation from both ends of wire, twist each wire, and fold stripped wires in half.

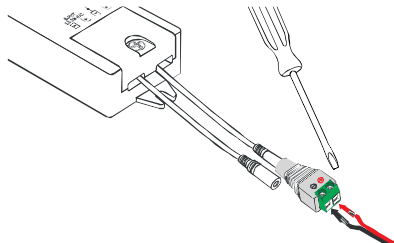

2. Insert Male Plug on Receiver into Female Barrel Connector. Use Flat blade screwdriver to loosen screws on Female Barrel Connector. Insert wires, Red wire to (+), Black wire to (-), and tighten screws.

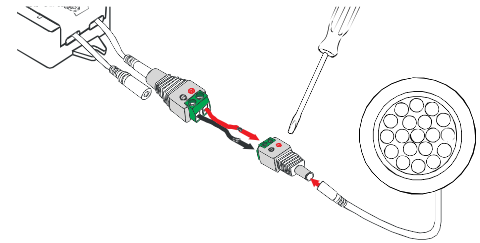

3. Insert Male Barrel Connector to Female Plug on Puck Light. Use Flat blade screwdriver to loosen screws on Male Barrel Connector. Insert wires, Red wire to (+), Black wire to (-), and tighten screws.

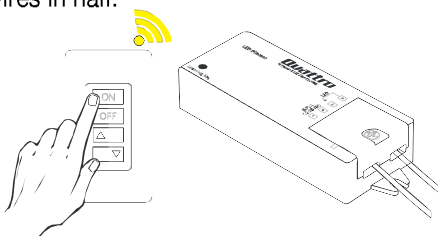

4. Turn on 120V AC to Power Supply and pair Receiver to Controller.

Pairing Instructions

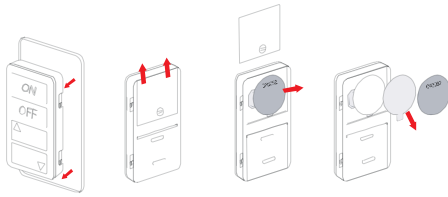

1. Remove Controller from back plate, slide battery compartment open, remove battery, and discard clear plastic tab. Reinsert battery, replace cover.

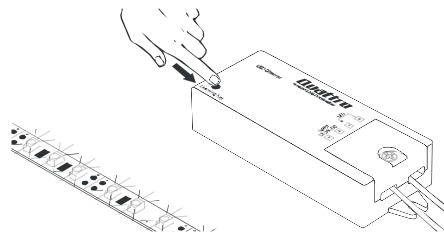

2. Clear the receiver by pressing and holding the Learning button until the lights blink twice

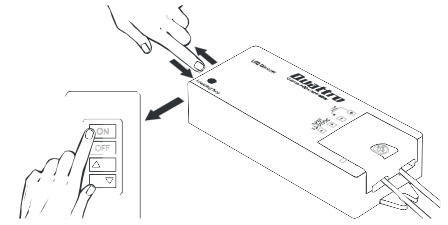

3. Quickly press and release the Learning button and, within 5 seconds, press and release one of the 1-Zone buttons on the Controller. When lights blink once, Controller and Receiver are paired.

Pairing Examples

1 Zone

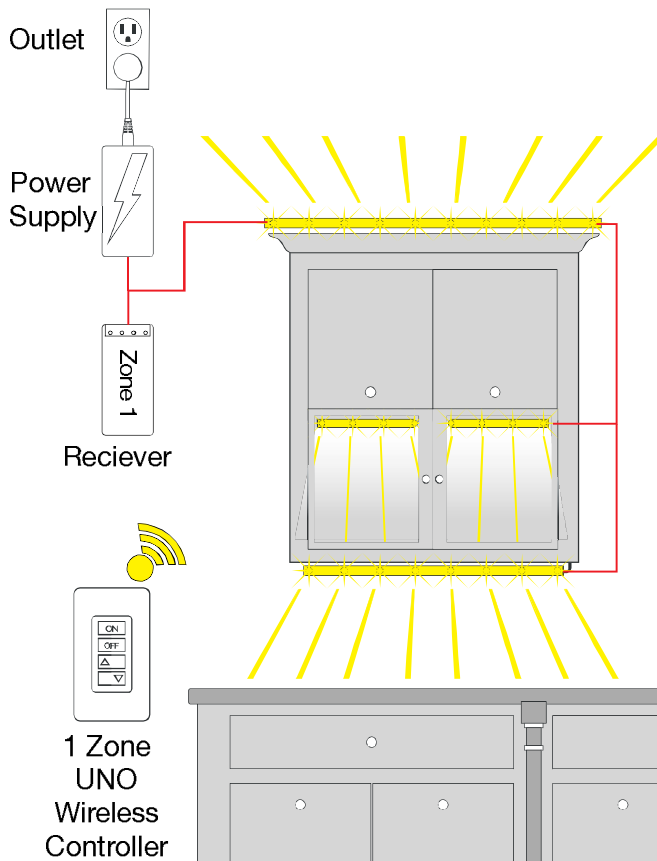

1 Zone

